

Lubrication system - exploded view of components

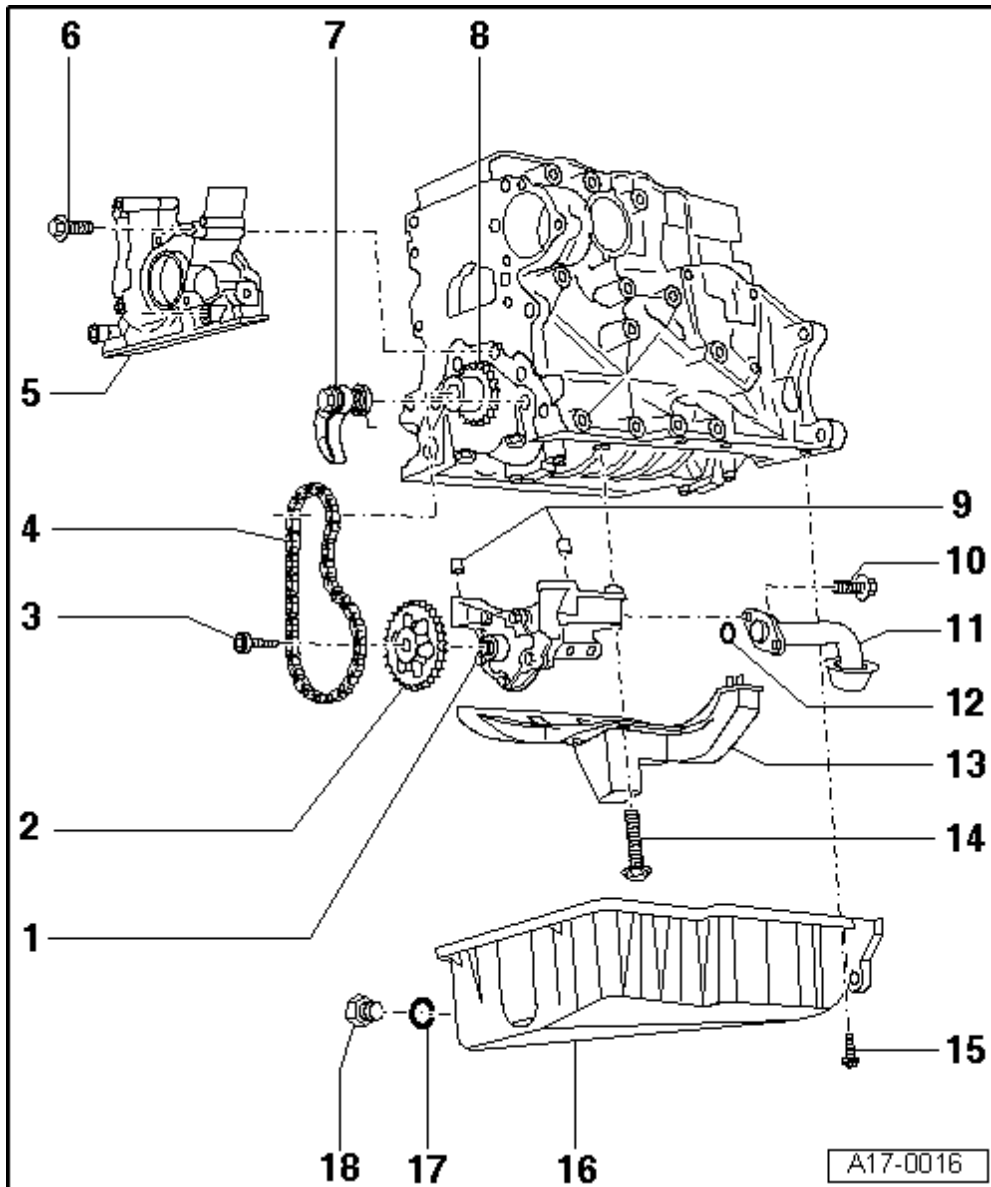

1 - Oil pump

q With pressure relief valve (12 bar)

q Removing and installing → [Chapter](#)

q Before installing, check that the two dowel sleeves → [Item](#) for centring oil pump/cylinder block are fitted.

q Renew if running surfaces and gears are scored

q Tightening torque for oil pump cover to oil pump housing: 10 Nm

2 - Chain sprocket for oil pump

q Sprocket can only be fitted on oil pump shaft in one position.

3 - 22 Nm

4 - Drive chain for oil pump

q Mark direction of rotation before removing

q Check for wear

5 - Sealing flange

- q Apply sealant prior to installing → [Chapter](#)
- q Renewing crankshaft oil seal on pulley end → [Chapter](#)
- 6 - 15 Nm
- 7 - Chain tensioner
- q Tighten to 16 Nm
- q Do not dismantle
- q Renew only as complete unit
- q Note installation position
- q When installing, pre-tension spring and engage
- 8 - Drive chain sprocket for oil pump
- q Removing and installing → [Chapter](#)
- 9 - Dowel sleeves
- q 2 x
- 10 - 15 Nm
- 11 - Intake pipe
- q Clean strainer if dirty
- 12 - O-ring
- q Renew
- 13 - Baffle plate
- 14 - 16 Nm
- 15 - 15 Nm
- 16 - Sump
- q Removing and installing → [Chapter](#)
- q Install using sealant; sealant → [Parts catalogue](#)
- 17 - Seal
- q Renew
- 18 - Oil drain plug, 30 Nm

- Oil spray jet and pressure relief valve
- 1 - Oil spray jet (for cooling of pistons)
 - 2 - Bolt with pressure relief valve, 27 Nm
 - 1 Opening pressure: 2.5 ... 3.2 bar.

